

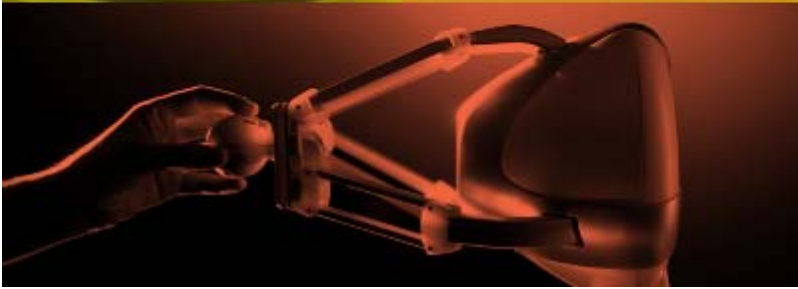

Travis Lee
Sustainable Design Lead





LUNAR

ELEMENTS

the designer's field guide to sustainability

an overview of sustainable product development and the product life cycle

Tips
Case Studies
Materials
Processes
Finishes

WHAT IS IT TRYING TO ACCOMPLISH?

HOW IS IT BROUGHT TO LIFE?

HOW IS IT USED?

WHERE DOES IT END UP?



QUESTION THE PREMISE OF THE DESIGN



MAXIMIZE RECYCLABLE, RENEWABLE AND BIODEGRADABLE MATERIALS



REDUCE SIZE AND WEIGHT



CREATE DURABLE AND HIGH QUALITY DESIGNS



MAKE IT MORE USEFUL



OPTIMIZE MANUFACTURING PROCESSES



DESIGN FOR UPGRADEABILITY



MINIMIZE FASTENERS



DESIGN PACKAGING IN PARALLEL



MAKE IT LESS COMPLEX



DESIGN FOR LIFE AFTER DEATH



MAKE IT MODULAR



REDUCE MATERIAL VARIETY



AVOID TOXIC OR HARMFUL MATERIALS AND CHEMICALS



DON'T USE PAINT IF POSSIBLE

This is a working document

We'd love you to submit your version to us, so we can update and improve this document in version 3.0.

elements@lunar.com









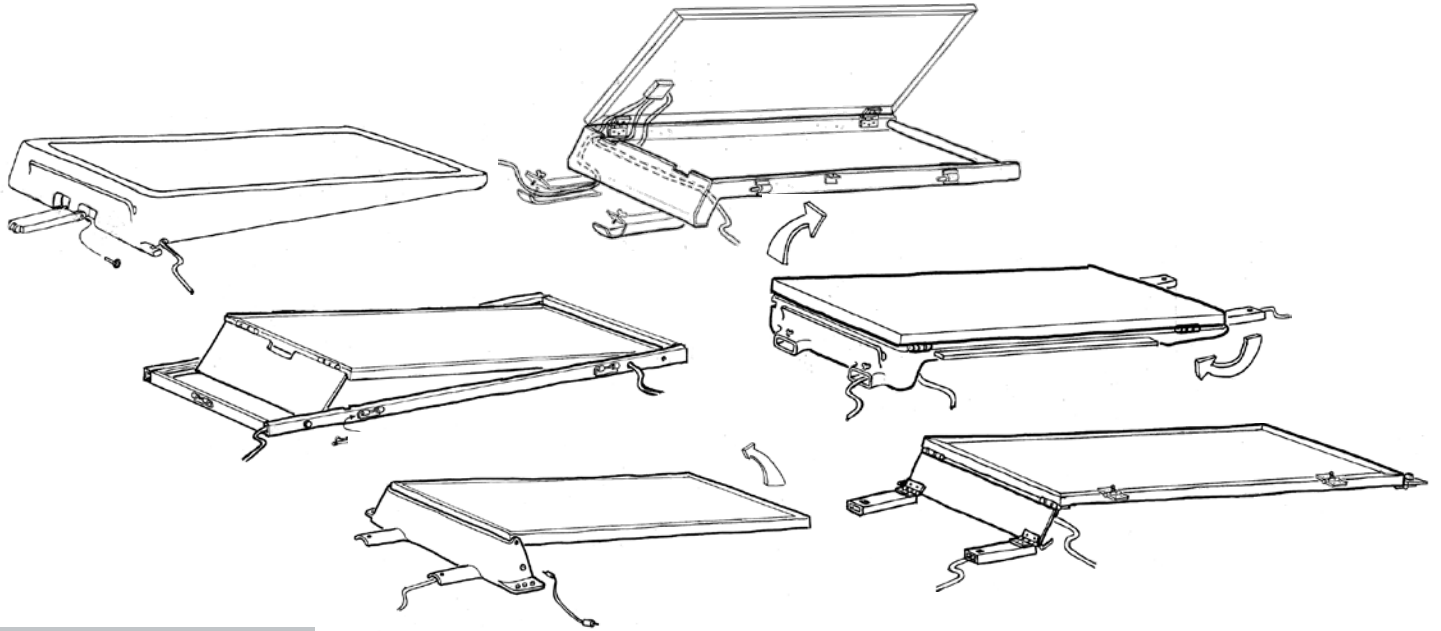

ships nested in pallets









Available in
**ultra soft,
soft, medium**

Handle
made from
**recycled
yogurt cups**

Return to Preserve
for **recycling**

Made in **USA**



Sturdy hang tab

Simple instructions for opening and closing

Light-weight package made from polypropylene and polyethylene to lighten the impact of manufacturing and shipping

Postage-paid mailer enables easy recycling





